

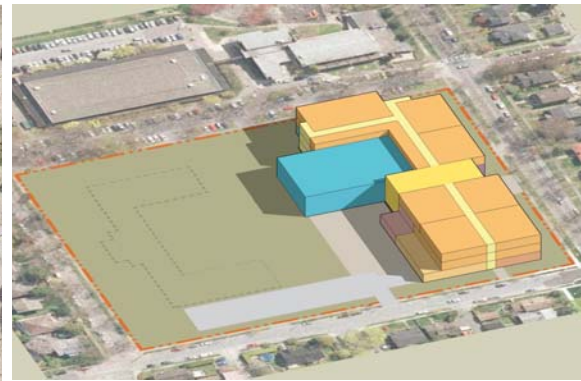

Concept E flips Concept D to extend along Larch Street, with the main entrance across from the Recreation Centre and Kitsilano Rink. Outdoor areas occupy the southwest site along Trafalgar Street.

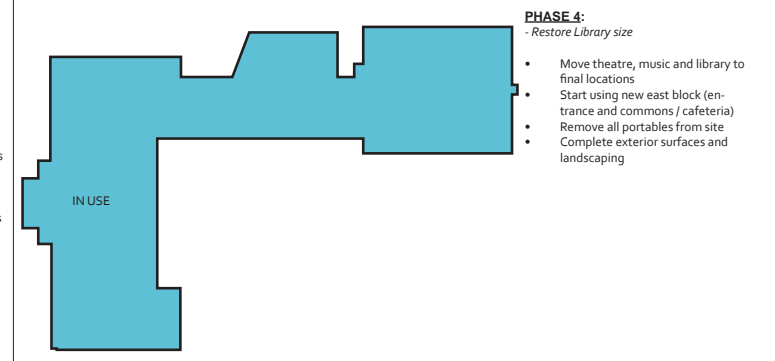

Concept F proposes a completely new three-storey school to be constructed along 12th Avenue, reusing the existing large gym and demolishing all other existing buildings.

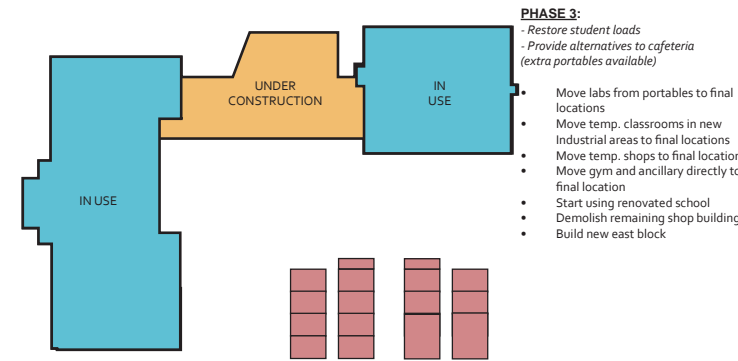
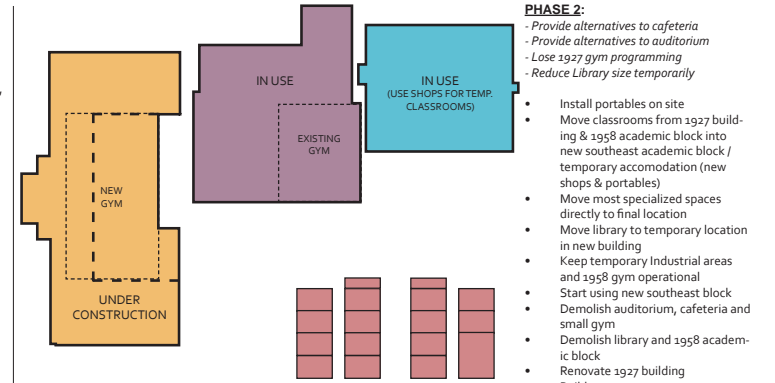
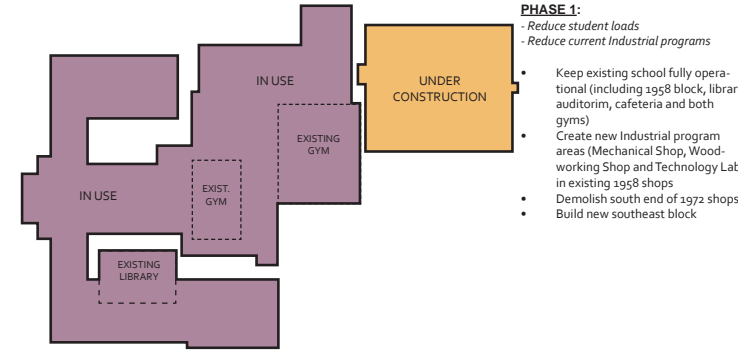
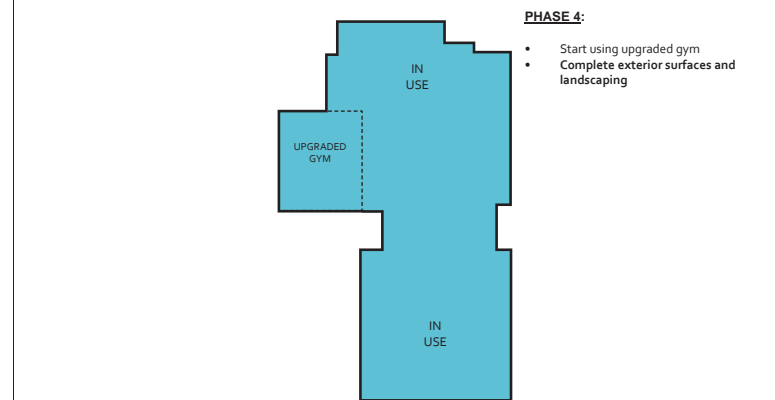
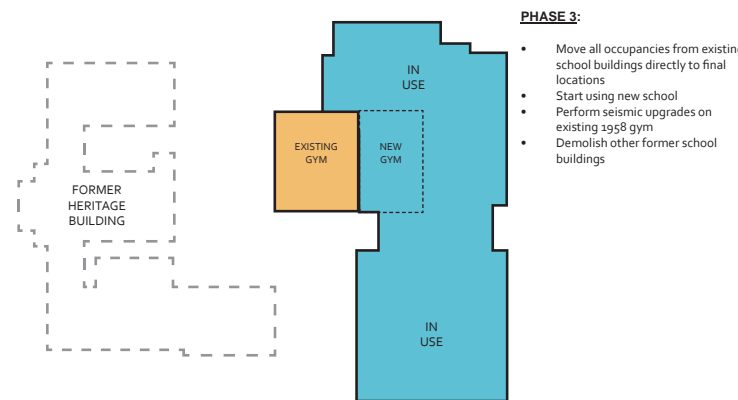
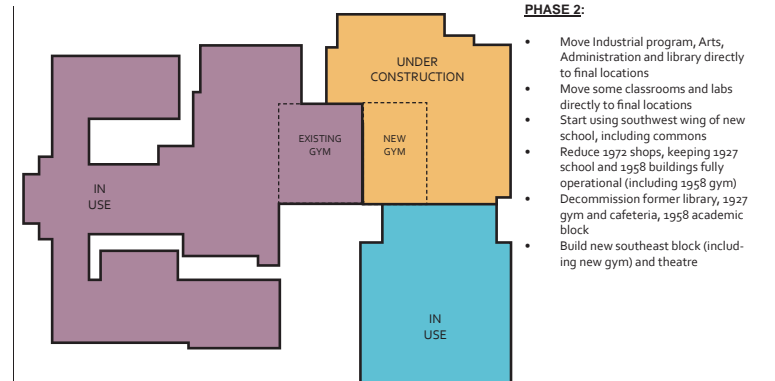
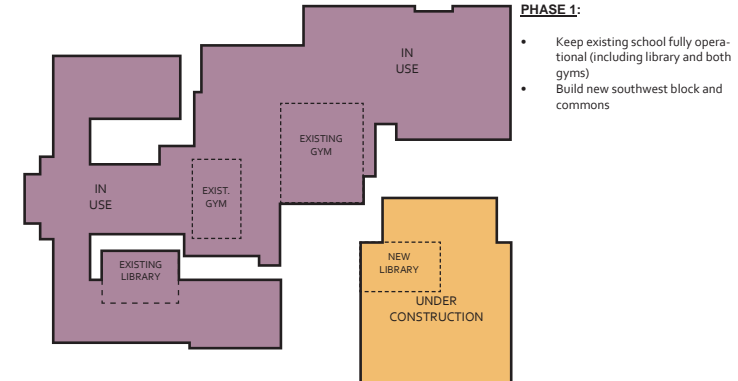

# Kitsilano Secondary School RENEWAL PLAN

## DESIGN CONCEPTS E-F

