

Safety & Continuity

Keeping the school open throughout construction is essential — closing it down and moving students away is not an option because all adjacent secondary schools are full. Construction will be done in a manner that ensures safety and security for everyone, as well as contiguous school operations.

Phasing should be as simple as possible so that construction time can be minimized. Issues relating to dust, noise and traffic will need to be managed and special care will be taken to protect existing trees. Many different options for phasing construction have been considered.



The Preferred Concept Design involves two main phases:

Phase 1

An academic block will be constructed on the tennis courts, and Kitsilano Secondary will continue to operate in the existing buildings.

Phase 2

Students and teachers will move into the newly completed academic space from the 1927 Block, but continue to occupy the rest of the school. A number of shops will be converted into classrooms prior to the move. Demolition within the 1927 Block will probably be scheduled during summer vacation, with reconstruction to follow. Upon completion of this work, students and teachers will move into the renewed 1927 block.

Phase 3

The gym and shops will be fenced off and demolished, so that the outdoor space can then be created.



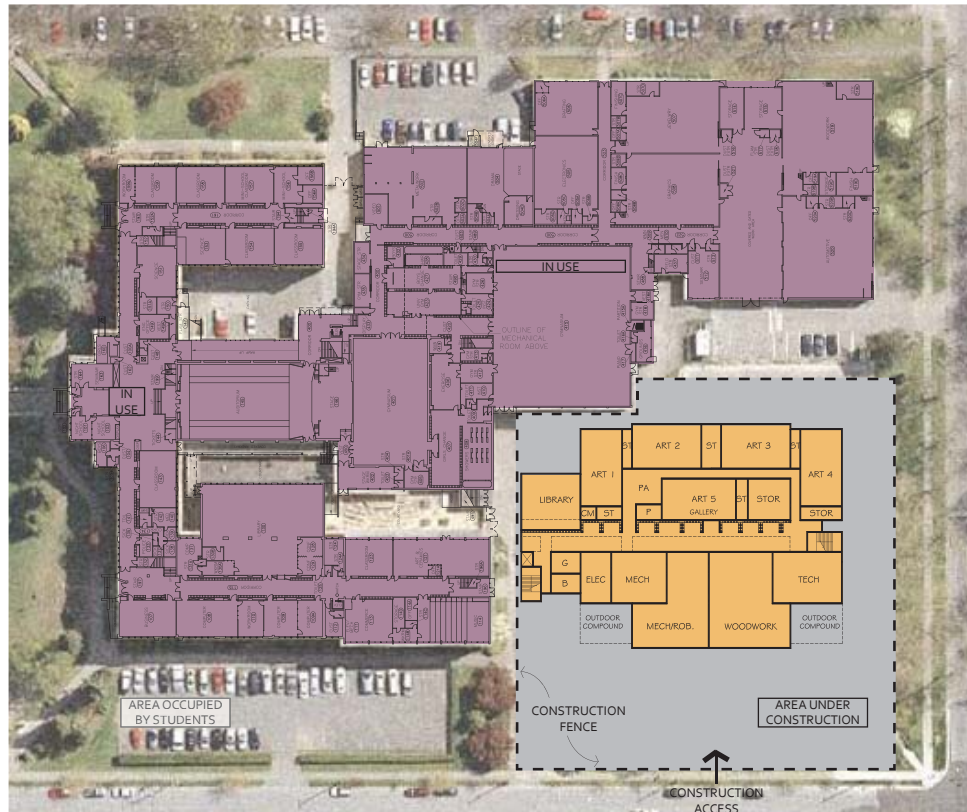

PHASE 1:
- Reduce student loads

- Keep existing school fully operational (including 1958 block, library, auditorium, cafeteria and both gyms)
- Build new southwest block (including part of new library) over existing tennis courts

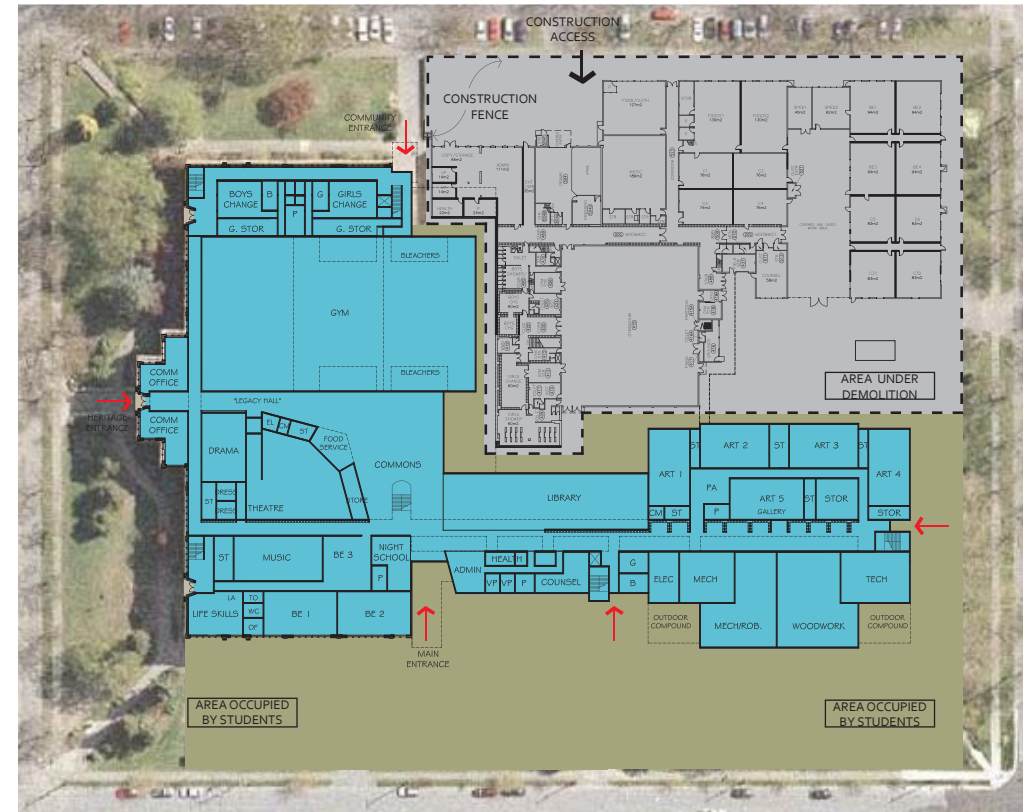

PHASE 3:
- Restore student loads
- Restore Library size

- Move all occupancies in temporary accommodations (shops) to final locations
- Move gym and ancillary directly to final location
- Start using new school
- Demolish remaining shops
- Complete exterior surfaces and landscaping

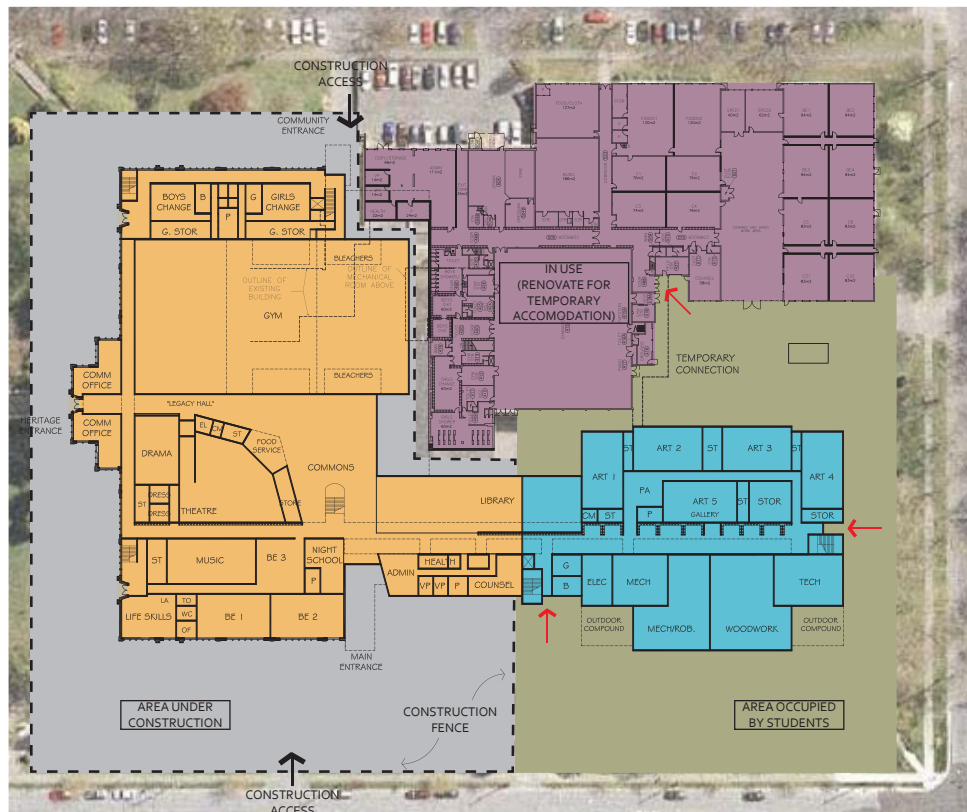

PHASE 2:
- Provide alternatives to cafeteria
- Provide alternatives to auditorium
- Lose 1927 gym programming
- Reduce Library size temporarily

- Move most specialized instruction spaces directly to final location in new southwest block
- Move remaining occupancies from 1927 building into new building / temporary accommodation in renovated shops
- Move new Industrial program areas (Mechanical Shop, Woodworking Shop and Technology Lab) into temporary locations
- Move library directly to partial final location
- Keep reduced shop buildings operational (including 1958 gym and reduced ancillary)
- Start using new southwest block
- Demolish auditorium, cafeteria, small gym and library
- Demolish part of 1958 shops
- Renovate 1927 building
- Build new gym

- NOT ACCOMMODATED IN PHASE 2:**
- 1 General Classroom (80 sm); 32 classrooms accommodated
 - 3 SPED classrooms (80 sm x3) + 1 Life Skills classroom (130 sm)
 - 1 Science classroom (140 sm)
 - Exercise room, Universal Gym

- UNDERSIZED SPACES / AREAS IN PHASE 2:**
- 2 SPED classrooms (-18 to -40 sm)
 - Counselling (-27 sm)
 - 4 Business classrooms (26 sm x4)
 - Library (-265 to -310 sm)



Kitsilano Secondary School RENEWAL PLAN

PHASING STRATEGY

