

SCHEME D.2 - PHASE 1 DIAGRAM

29 JANUARY, 2010

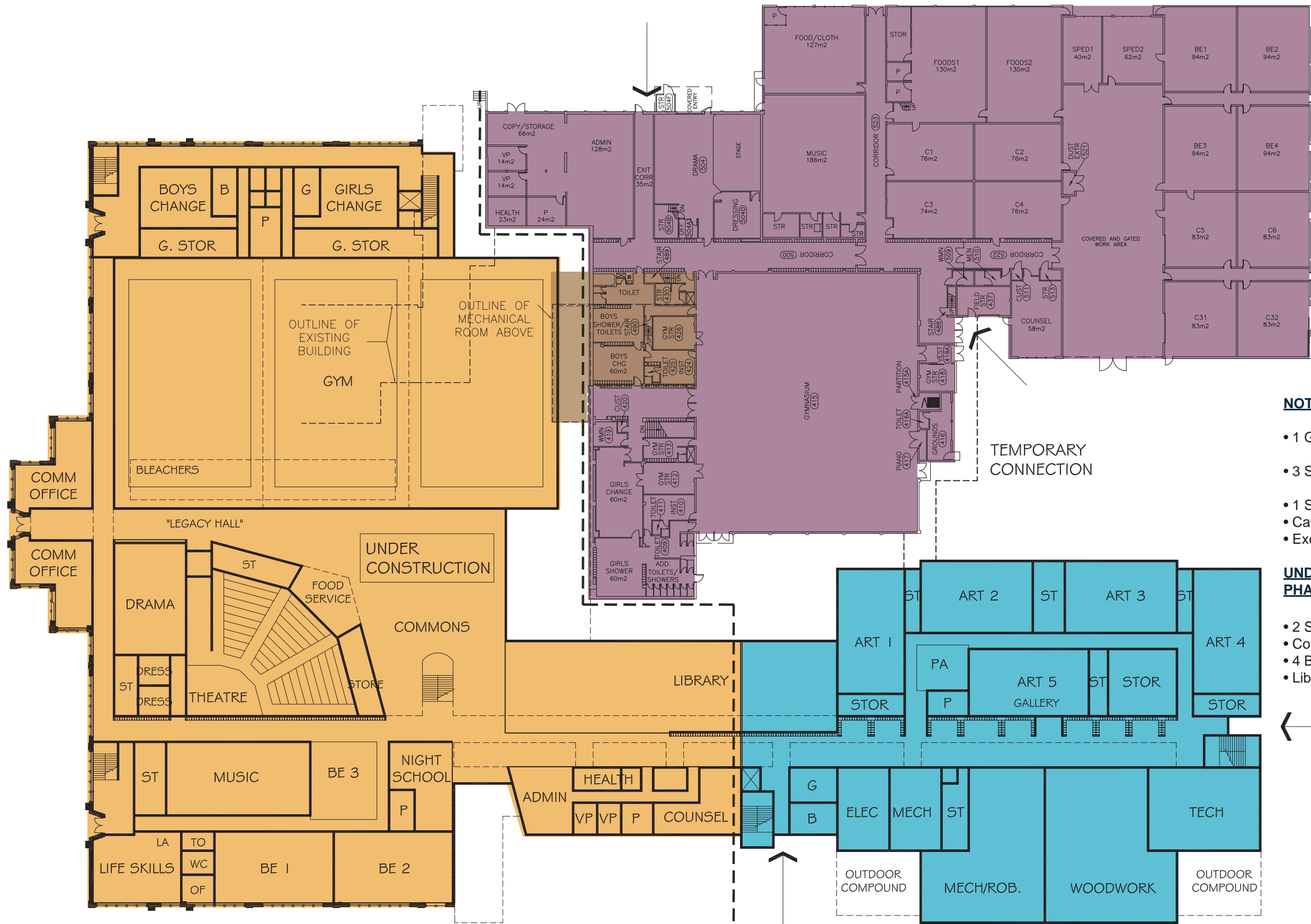

Kitsilano Secondary School RENEWAL PLAN



NOT ACCOMODATED IN PHASE 2:

- 1 General Classroom (80 sm); 32 classrooms accomodated
- 3 SPED classrooms (80 sm x3) + 1 Life Skills classroom (130 sm)
- 1 Science classroom (140 sm)
- Cafeteria
- Exercise room, Universal Gym

UNDERSIZED SPACES / AREAS IN PHASE 2:

- 2 SPED classrooms (-18 to -40 sm)
- Counselling (-27 sm)
- 4 Business classrooms (26 sm x4)
- Library (-265 to -310 sm)



**Kitsilano Secondary School
RENEWAL PLAN**



SCHEME D.2 - PHASE 2 DIAGRAM

29 JANUARY, 2010